

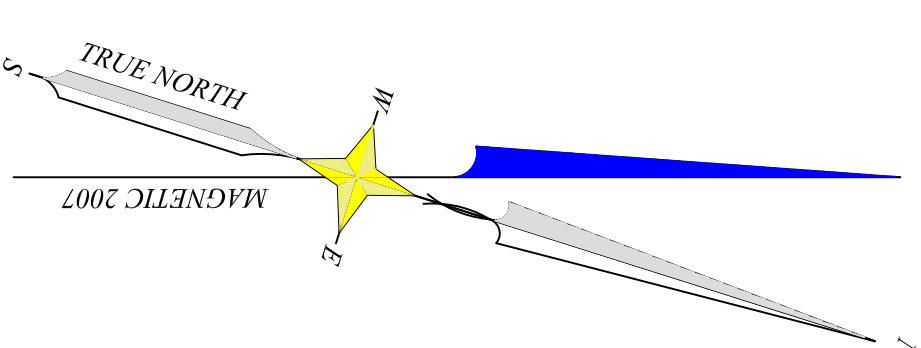

LOCUS MAP
BAR HARBOR 1982
USGS QUAD SHEET
SCALE 1" = 2000'



SURVEYOR'S NOTES:

All directions are Magnetic North, derived from a bearing taken with a hand compass to the nearest 1/4 degree in the year 2007.

Elevations are based on assumed datum of 100 feet on the largest island at the intersection of Mount Desert & Eden Streets. Two temporary benchmarks for the project are as shown at each fire hydrant.

Underground utilities are as marked per American Public Works Association color standards (quick reference shown hereon) on the surface by the inhabitants of the Town of Bar Harbor Water & Wastewater departments and dig safe contractor On-Target.

Centerline stationing along Mount Desert Street is based on 0+00 at the intersection with Main Street. This is for general information only and should not be used for any official proceedings having to do with right-of-ways.

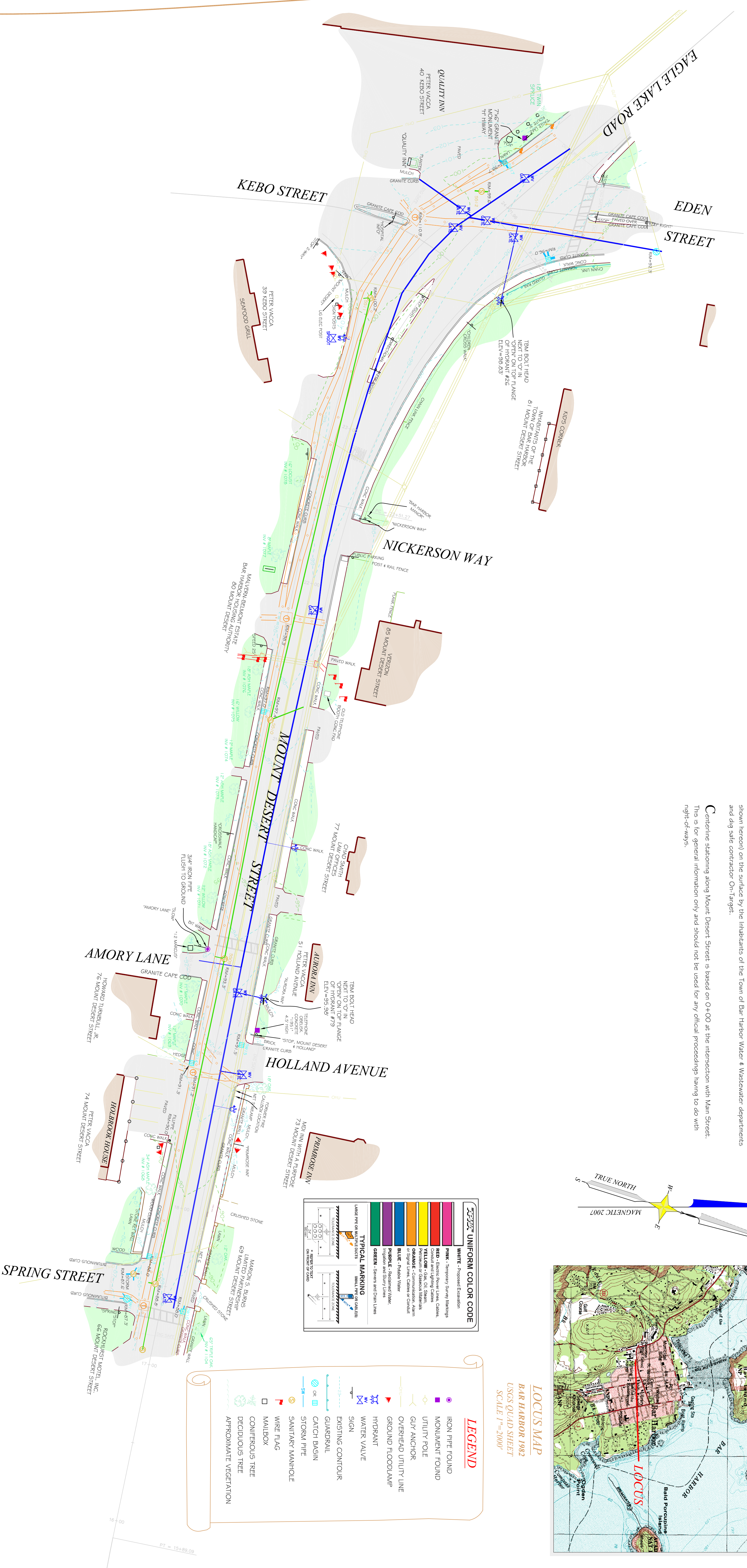

2022c UNIFORM COLOR CODE

WHITE	Proposed Elevation
PINK	Proposed Survey Markings
RED	Proposed Utility Lines
ORANGE	Proposed Utility Lines
YELLOW	Oil, Oil Storage, or Signal Lines, Cables or Conduit
GREEN	Communication, Alarm or Signal Lines, Cables or Conduit
BLUE	Public Water
PURPLE	Proposed Markings
BROWN	Proposed Markings
GREEN	Shrubs and Drain Lines

TYPICAL MARKING

- Iron pipe found
- Monument found
- Utility pole
- Guy anchor
- Overhead utility line
- Ground floodlamp
- Hydrant
- Water valve
- Sign
- Existing contour
- Guardrail
- Catch basin
- Storm pipe
- Sanitary manhole
- Wire flag
- Mailbox
- Coniferous tree
- Deciduous tree
- Approximate vegetation

LEGEND

- IRON PIPE FOUND
- MONUMENT FOUND
- UTILITY POLE
- GUY ANCHOR
- OVERHEAD UTILITY LINE
- GROUND FLOODLAMP
- HYDRANT
- WATER VALVE
- SIGN
- EXISTING CONTOUR
- GUARDRAIL
- CATCH BASIN
- STORM PIPE
- SANITARY MANHOLE
- WIRE FLAG
- MAILBOX
- CONIFEROUS TREE
- DECIDUOUS TREE
- APPROXIMATE VEGETATION

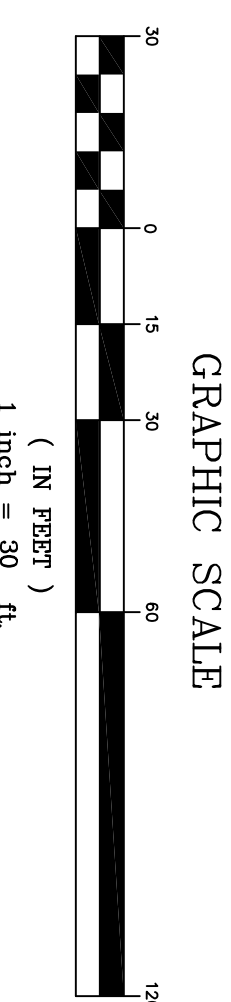

TOPO

PATRIOT LANDSURVERS

100 Highland Road
Bar Harbor, Maine 04609
Tel: 207-583-9300
www.patriotlands.com

CLIENT/PROJECT: **INHABITANTS OF THE TOWN OF BAR HARBOR**

SHEET TITLE: **WATER LINE PRE-CON TOPOGRAPHICAL SITE PLAN**

LOCATION: **MOUNT DESERT STREET**

SCALE: **1 inch = 30 feet**

TOWN: **BAR HARBOR** COUNTY: **HANCOCK** STATE: **MAINE** DATE: **DECEMBER 18, 2007** DRAWN BY: **JBPPC**

NO.	REVISIONS	DATE

